

# Head Record

Product description

Instructions for use

Maintenance

Abnormal handling

Safety instructions

Warranty notice

# Product description

1. Host
2. Hose
3.  $\Phi 40$  metal elbow
4.  $\Phi 40$  metal straight pipe
5. Absorbent brush
6. Big flat suction
7.  $\Phi 40$  round brush
8. Universal wheel
9. Power cord

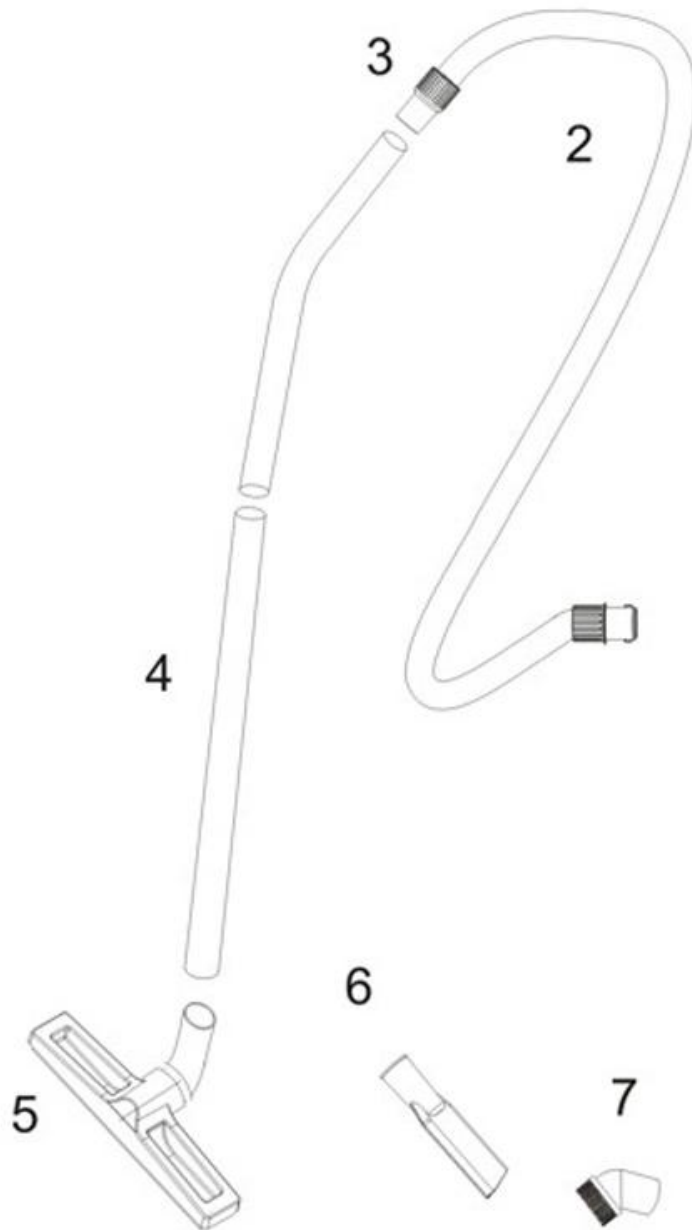

## ⚠ Note

1. Please take out the hose assembly from the metal grid before installing and using the product.
2. When cleaning high places, accessories can be installed on the metal pipe.
3. Subject to the purchased package.

# Instructions for use

Assemble the accessories for the first time.

Please follow the instructions in the figure below to complete the product assembly

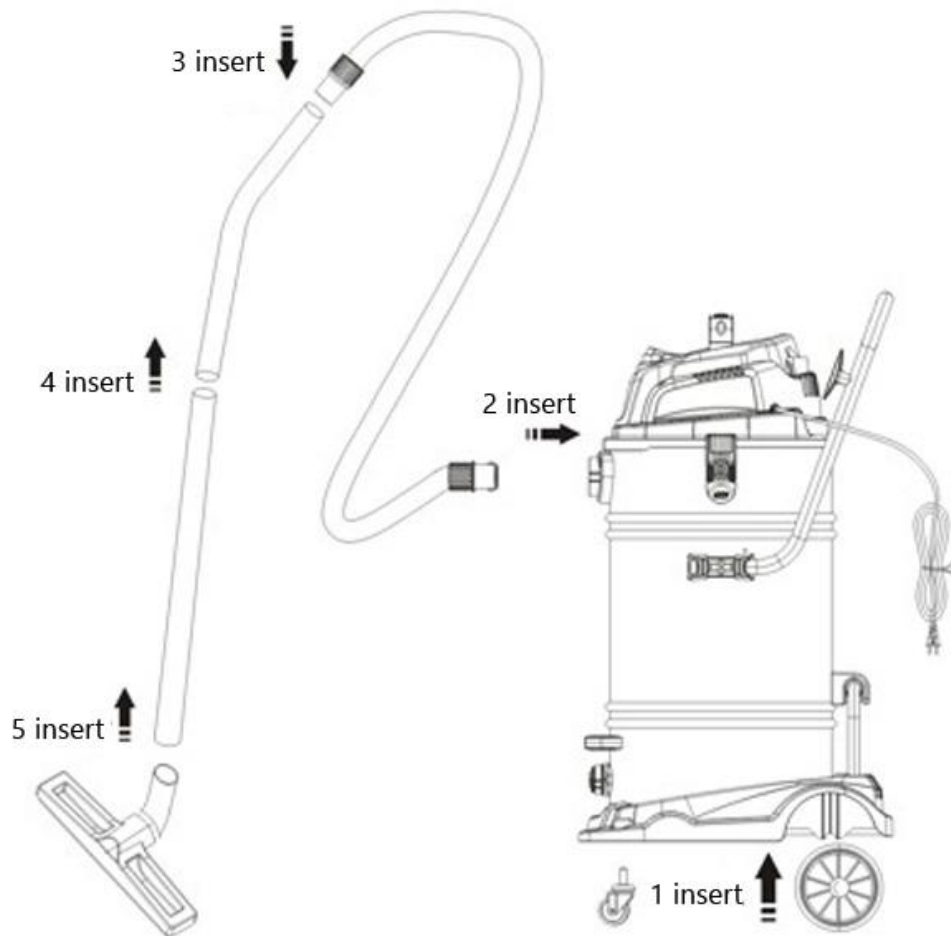

1. Connect the universal wheel to the vacuum cleaner: Before operating the vacuum cleaner, please insert the universal wheel connector into the universal wheel interface of the barrel.
2. Connect the hose to the air inlet of the vacuum cleaner: Before vacuuming, please insert the hose connector clockwise into the air inlet of the barrel. If you want to remove it, turn it clockwise against the wind and pull it out.
3. Straight pipe and hose connection: Insert the hose into the  $\Phi 40$  metal elbow in the direction shown in the figure.

4. Connect the metal elbow to the metal straight pipe: align the metal elbow with the bump direction then, it can be installed in place.
5. Metal connecting pipe and floor brush connection: The metal connecting pipe interface is aligned with the floor brush connector, please apply insertion force and rotate to make the connection firm, and apply rotating force to facilitate pulling out when disassembling.

## Other accessories

### Accessory use

Large flat suction: suitable for sucking dust from furniture gaps, corners, ceilings and other small gaps.

Φ40 round brush: suitable for sucking dust from small gaps such as window seams, corners, and sofa seams.

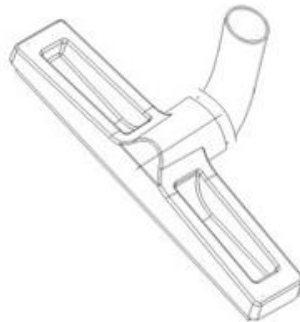

Water-absorbing brush:  
The water-absorbing brush has a scraper, which is suitable for removing dirt on large areas such as water-logged floors

# Clean up

## First time operation

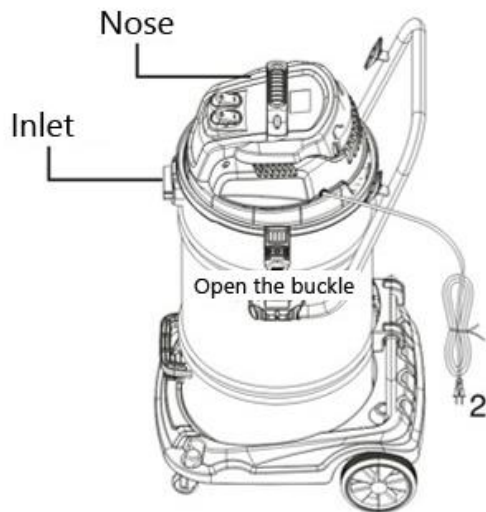

1. Check the dust collection: open the buckle, open the simplified body, ensure the dust filter and HEPA already assembled in place.
2. Put down the power cord to connect to the power supply: use the vacuum cleaner to place the power cord on the ground, and insert the plug into the socket.
3. Press the switch button: start and stop the barrel suction.

## ▲ Note

1. It needs to be assembled in place before use.
2. Do not coil the power cord around the head of the bucket suction machine, block the air inlet and outlet, and cause the bucket suction to overheat and damage the motor.

# Maintenance

## Dump dust

1. Open the barrel suction head/return the head: open the buckle button and remove the head. Take out the dust compartment.
2. Dumping garbage: Tilt the bucket body to pour out the garbage.

Nose

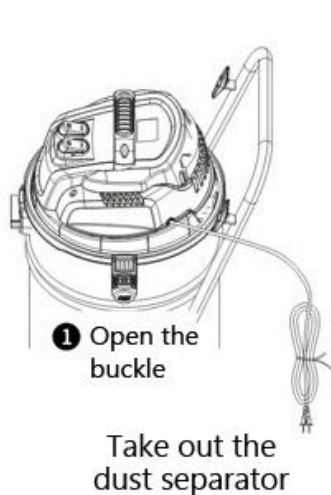

02. Dump the garbage:  
Tilt the barrel to dump the garbage



## Maintenance

1. Check the dust collection: open the buckle, open the simplified body, ensure the dust filter and HEPA already assembled in place.
2. Put down the power cord to connect to the power supply: use the vacuum cleaner to place the power cord on the ground, and insert the plug into the socket.
3. Press the switch button: start and stop the barrel suction.

### ▲ Note

1. The dust filter and HEPA need to be cleaned irregularly after use to avoid clogging and affecting suction.
2. The manual is the general type; the specific configuration is subject to the purchase package configuration.

# Abnormal handling

If you find abnormalities in the use of this product, please refer to the table below first.

Abnormal situation	Possible causes	Approach
Vacuum cleaner not working at all	The power plug is not firmly inserted into the socket. The power socket is not powered. The switch of the vacuum cleaner is not turned on.	Reinsert the plug and press the machine power switch
Suction weakened	Pipeline channel blockage. The water level in the barrel is too high. Severe dust accumulation in dust separator or HEPA.	Clear the blockage. Empty the stagnant water. Clean up HEPA and dust filter.

For other failures that cannot be handled, please contact the local after-sales service outlet or call the national service hotline: 400-8228-499

# Safety instructions

## Safety warning

- Do not place the vacuum cleaner close to heat sources, radiation or burning cigarette butts. It is strictly forbidden to inhale the following objects,
  1. With corrosive substances.
  2. Lime, cement ash and other construction dust and garbage.
  3. Heating objects, such as unextinguished carbon heads and cigarette ends.
  4. Sharp pieces such as glass etc.
  5. Inflammable and explosive items, such as gasoline or alcohol products;
- Do not let children play with or operate the vacuum cleaner to avoid accidents;
- Your vacuum cleaner is an electric appliance: it must be used in accordance with normal use conditions, and never leave the vacuum cleaner running alone without supervision;
- When cleaning, repairing or temporarily not using the vacuum cleaner, the power supply must be cut off;
- Cut off the power supply: Do not pull the power cord, but hold the plastic part of the plug with your hand to unplug the plug;
- Check that the power supply voltage must be consistent with the voltage used by the vacuum cleaner;
- Do not let the power cord of the vacuum cleaner pass through sharp objects, so as not to damage the power cord;
- Do not immerse the vacuum cleaner in water, avoid close to heating appliances or expose to the sun, so as to avoid fire;
- In the following situations, please do not use the vacuum cleaner, and send it to the maintenance department designated by the company for repair in time
  1. It has been dropped and is obviously damaged or malfunctioning;
  2. The power cord is damaged;
- Avoid running for a long time with the suction port blocked to avoid damage to the motor and heat deformation of the vacuum cleaner.



# Warranty notice

Jenuo vacuum cleaner strictly follow the national "New Three Guarantees" regulations for warranty service. Users will provide relevant free maintenance services under the condition of normal use of the product.

- Three-month warranty for accessories and three-year warranty for motors
- Warranty period definition:
  1. The starting date of the warranty period shall be the date of issuance of the valid warranty certificate;
  2. If there is no valid warranty certificate, the starting date of the warranty period shall be 6 months after the date of manufacture;
  3. If there is neither a valid warranty certificate nor a date of manufacture, the starting date of the warranty period shall be 6 months after the earliest listing date of the product;
  4. The 15 days of online shopping products are regularly calculated based on the date of receipt, and the later warranty can be calculated based on the date of invoice.
- The parts repaired and replaced within the warranty period belong to the company, and the parts repaired and replaced outside the warranty period belong to the user;
- Other matters shall be carried out in accordance with the national "New Three Guarantees" regulations;
- In any of the following situations is not covered by the warranty:
  1. Vacuum cleaner accessories (metal telescopic tube/plastic intubation tube, hose, floor brush, small accessories, etc.), consumables (filter element, dust bag, etc.) and standard products;
  2. Damaged due to improper handling, use, maintenance and storage by the user;
  3. Damaged by using voltage higher or lower than 220V;
  4. Failure to use, maintain and maintain the product in accordance with the requirements of the product instruction manual and cause damage;
  5. Not disassembled and repaired by our professional service personnel;
  6. Damage caused by force majeure (such as lightning, fire, earthquake, flood and other natural disasters);
  7. Products beyond the warranty period;
  8. The model or number recorded on the invoice or warranty card does not match the actual product.

In the above cases, our company will implement fee-based maintenance. The types of fees include maintenance fees and parts fees. The specific fee standards are within the allowable range of relevant departments. The original agents, dealers and retailers are responsible for the extra services and additional non-original configuration gifts promised by agents, distributors and retailers.

## Attention

---

1. If you find that the product needs service, please directly contact the local special service outlet or our service hotline: 400-8228-499
2. If you send a letter, please prepare your contact number so that you can get a reply as soon as possible.